

AIE900A-A0 NEW

Fanless Edge AI System with NVIDIA® Jetson AGX Orin™ 32GB, 1 HDMI, 2 2.5GbE, 8 PoE, 6 USB, 8-CH DI/DO, and 2 COM/CAN for 5G and Robotics Applications

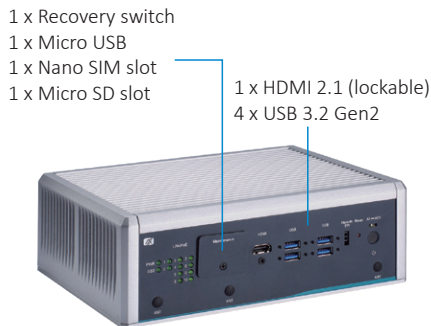

▲ Front view

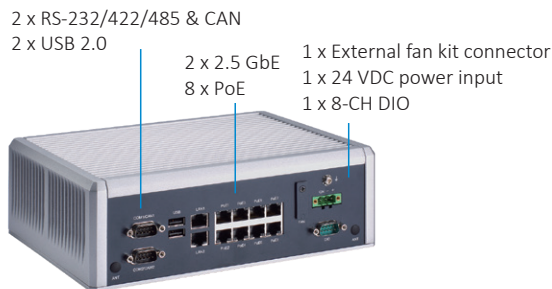

▲ Rear view

Features

- NVIDIA® Jetson AGX Orin™ 32GB (200 TOPS)
- Seamless speed: 5G, Wi-Fi 6E, and 2.5 GbE combined
- 24VDC with Ignition (e-Mark compliance)
- Supports 8 PoE and GMSL for camera and LiDAR connectivity
- -25°C to +50°C operating temperature range
- Supports device management and optional OTA deployment powered by Allxon

NVIDIA® Jetson AGX Orin™ will be available until 2030*

The official end of life notice will be sent at least 8 months before the last shipment.



Specifications

Standard Color	Silver
Construction	Aluminum extrusion and heavy-duty steel, IP40
AI Accelerator	NVIDIA® Jetson AGX Orin™ 32GB (200 TOPS)
CPU	8-core NVIDIA Arm® Cortex A78AE v8.2 64-bit CPU 2MB L2 + 4MB L3
GPU	1792-core NVIDIA Ampere™ GPU with 56 Tensor Cores
System Memory	32GB 256-bit LPDDR5 204.8GB/s
Carrier Board	PSB906
System I/O Outlets	1 x Lockable HDMI 2.0 with 4K2K supported 2 x 10/100/1000/2500 Mbps Ethernet (Intel® I226) 8 x 10/100 Mbps PoE (up to 60W) 2 x DB9 for CAN & RS-232/422/485 4 x USB 3.2 Gen2 2 x USB 2.0 1 x 8-CH DI/DO 1 x Remote switch, 1 x Reset button, 1 x Power button, 1 x AT/ATX switch 1 x Micro USB & 1 x Recovery switch (for image update) 1 x 24 VDC power input connector 5 x SMA-type antenna opening
Watchdog Timer	Built-in AGX Orin
Storage	Onboard 64GB eMMC (via Jetson AGX Orin™) 1 x M.2 Key M 2280 with PCIe x4 NVMe SSD slot 1 x Micro SD slot *The bootable device is supported by eMMC only

Specifications

Expansion Interface	8CH GMSL/FPD-LINK/V-by-One Automotive camera interfaces (optional) 1 x Full-size PCI Express Mini Card slot (USB + PCIe) 1 x M.2 Key E 2230 slot for Wi-Fi 6(E) 1 x M.2 Key B 3052/3042 slot for 5G/LTE 1 x Nano SIM slot
System Indicator	1 x Green LED for system power-on 1 x Green LED for M.2 storage 2 x Green LED for LAN status 8 x Green LED for PoE status
Power Supply	24 VDC with ignition power control
Operating Temperature	-25°C to +50°C (-13°F to +122°F)
Humidity	10% - 95%, non-condensing
Vibration Endurance	3 Grms with M.2 (5 to 500Hz, X, Y, Z directions)
Dimensions	239 mm (9.41") (W) x 185.3 mm (7.3") (D) x 79.4 mm (3.13") (H)
Weight (net/gross)	3 kg (6.61 lb)/3.65 kg (8.04 lb)
Certifications	CE, FCC Class A, UKCA
OS Support	Linux Ubuntu 20.04 or later

Packing List

1 x Terminal block connector
1 x Screw pack
4 x Foot pad
1 x M.2 SSD thermal kit
1 x 5G module thermal kit

Power Protection

DC Adapter

OVP (over voltage protection)
OCP (over current protection)
UVP (under voltage protection)
Reserve protection

Ordering Information

Standard

AIE900A-AO-2L8P	Fanless edge AI system with NVIDIA® Jetson AGX Orin™ 32GB, 1 HDMI, 2 2.5GbE, 8 PoE, 6 USB, 8-CH DI/DO, and 2 COM/CAN
-----------------	--

Optional

8817H9005AOE	Wall mount kit
8817H9007AOE	DIN-rail kit
8817H9008AOE	VESA mount kit
	M.2 NVMe SSD 128GB or above
50906A24000E	24V/230W adapter
	Power cord
	5G module kit
	LTE module kit
	Wi-Fi module kit
	External fan kit

* Specifications and certifications may vary based on different requirements.

Dimensions

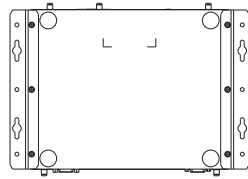
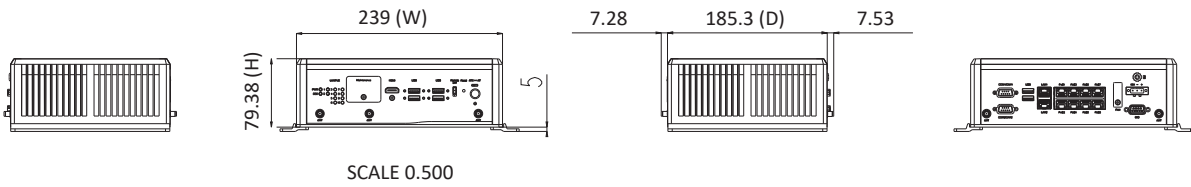
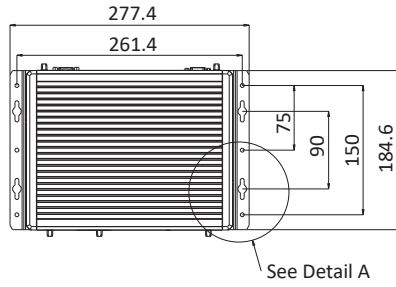
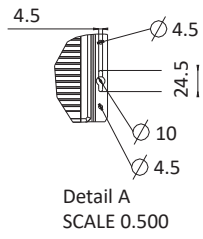

Wall-mount is an optional kit